



Barrel adapter made of polypropylene

(PP and PVDF pump tube) for fixing the barrel pump in the bung hole of a drum, diameter of pump tube 41 mm, G 2"

Ø 41

9001

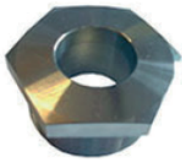

Barrel adapter made of stainless steel

For secure fixing of drum pump in bung hole of a drum, diameter of pump tube 41 mm, G 2"

Ø 41

9002



Emission proof drum adapter

For pump tube diameter 41 mm
FKM-seals prevent emission of harmful gases and vapours out of the drum. A vacuum in drum is equalized by a valve.

made of polypropylene

made of brass

made of stainless steel 316.

9024

9025

9026



Bounding ground set

Set consisting of 4 cables with connection clamps.

These ground wires with connection clamps are absolute necessary when pumping flammables or for use in hazardous areas.

This set can be used as an electric conductive connection between the drum pump and the container for earthing and balancing out the energy resources.

9003



Strainer

For protection the barrel pump when abrasive particles are present.

Polypropylene. Size of slots 1,5 x 12 mm, tube-Ø 40, 41 or 42 mm

Stainless steel 316. Size of slots 1,5 x 20 mm, tube-Ø 41 mm

PP

9011

SS

9012

PVDF

9230



Nozzle made of polypropylene

Housing and internal parts in polypropylene
Valve seat and seals made of FKM or EPDM
Rotatable hose connection
Flow rate: 80 l/min
Viscosity: 800 mPas
Operating pressure: 3 bar
Weight: 210 g

FKM	1"	9103
EPDM	1"	9106



Nozzle made of PVDF

Housing and internal parts in PVDF
Valve seat and seals made of FKM
Rotatable hose connection
Flow rate: 80 l/min
Viscosity: 800 mPas
Operating pressure: 3 bar
Weight: 210 g

FKM	1"	9109
-----	----	------



Nozzle made of stainless steel 316

Housing and internal parts in SS 316
Valve seat and seals made of PTFE
Hose connection 1"
Flow rate: 80 l/min
Viscosity: 900 mPas
Operating pressure: 4 bar
Medium temperature: max. 80 °C
Weight: 1 kg

	1"	9013
--	----	------



Nozzle made of aluminium

Housing and internal parts in ALU
Valve seat and seals made of NBR
Hose connection 1"
Flow rate: 60 l/min*
Hose connection ALU

	1"	9032
--	----	------



Electronic flow meter FM I20

Turbine gear meter
are suitable for low viscous, water-like media and are
available in PP, PVDF and stainless steel.

PP	9020
PVDF	9021
SS	9008

